



Diamond Tub & Showers Spec Sheet

Model: SLS 483781

Description: One Piece Shower Unit with Left Seat

Specifications

Model #	Material	Wall Finish	Pieces	Drain	Threshold Height	Net Weight Lbs.
SLS 483781	Fiberglass/Gelcoat	Smooth	1	C	7 1/2"	
Enclosure Opening						
Width	Height					
43 3/4"	72"					

Framing Dimensions

A	B	C	D
48"	19"	24"	37"

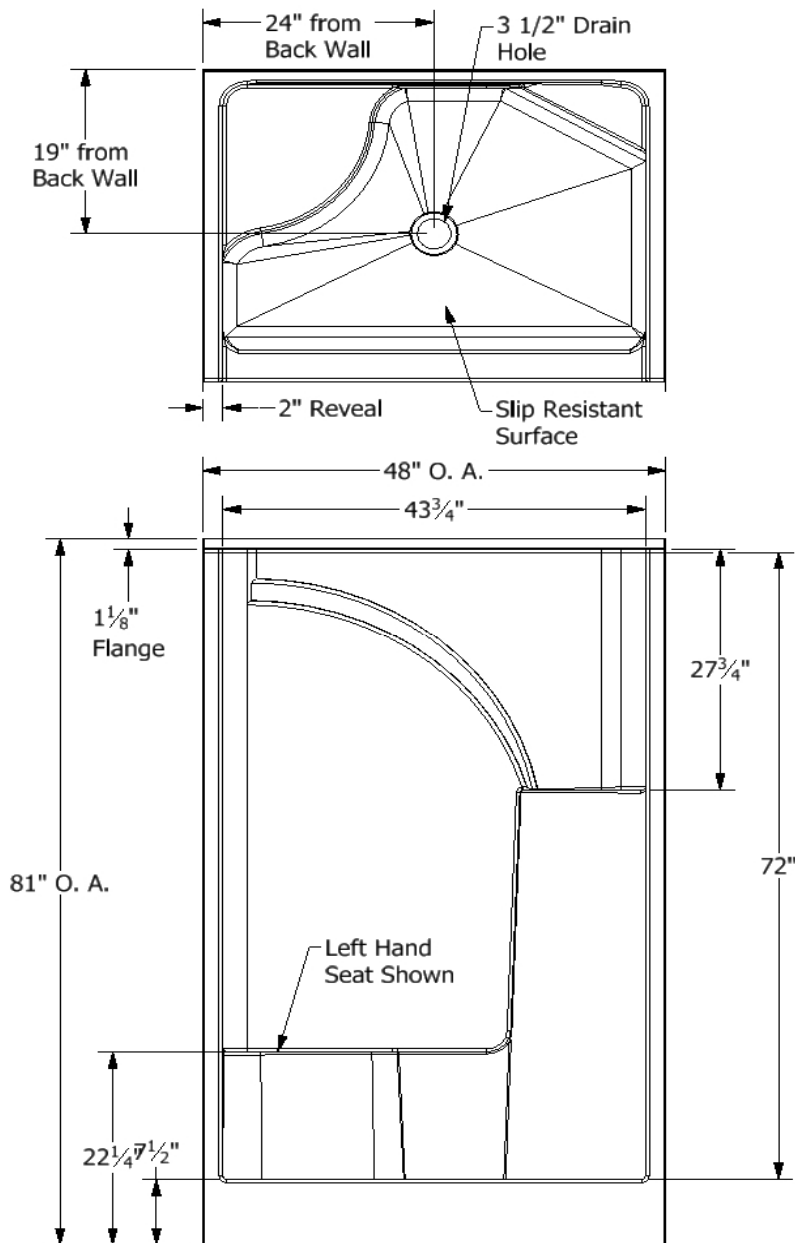

Framing Specifications

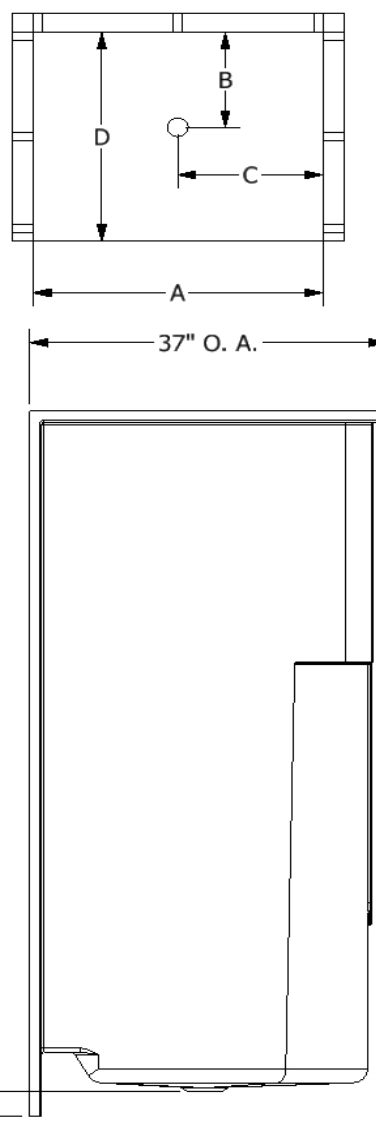

Certified to conform to HUD/UM73b, ANSI Z124.1, and ASTM E-162 Flame Spread Rating 200 or less and is under a program of factory inspection.

Manufactured by Frontline Mfg., Inc. Leesburg, IN



2/28/13